

NEW-YORK HISTORICAL SOCIETY MUSEUM & LIBRARY

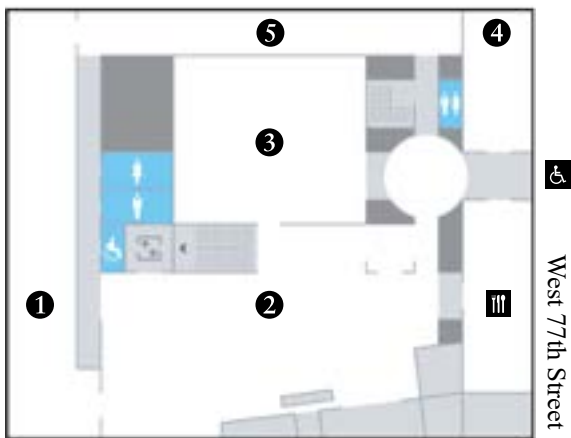
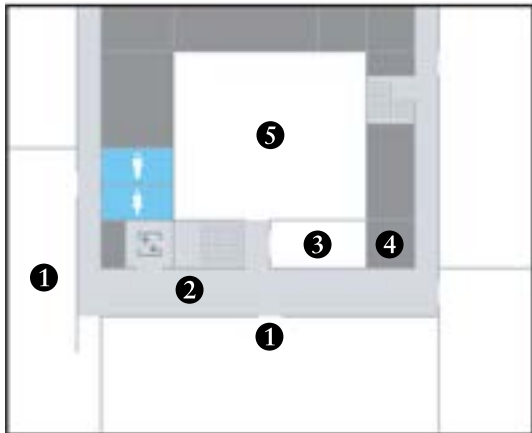
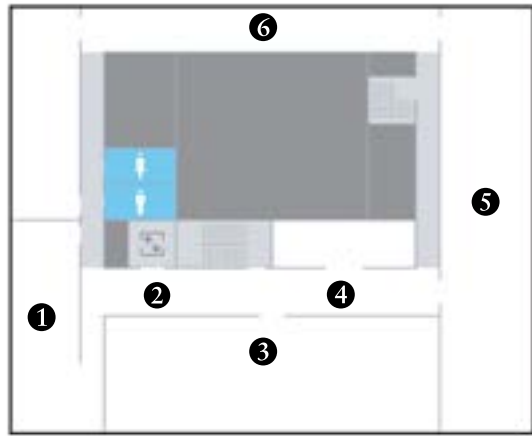

Central Park West

LEVEL FOUR HENRY LUCE III CENTER

- ❶ Art for Change: The Artist & Homeless Collaborative
Joyce B. Cowin Women's History Gallery
- ❷ Center for Women's History
- ❸ Gallery of Tiffany Lamps
- ❹ Roy J. Zuckerberg Hall of American Silver
- ❺ North Gallery: Permanent Collection
- ❻ Meet the Presidents & Oval Office

4

LEVEL TWO

- ❶ Scenes of New York City: The Elie and Sarah Hirschfeld Collection
Dexter Hall & Luman Reed Galleries
- ❷ "Turn Every Page": Inside the Robert A. Caro Archive
Dexter Corridor
- ❸ Aristotle: From Antiquity to the Modern Era
Pam & Scott Schafler Gallery
- ❹ Audubon Birds of America
Krystyna Doerfler Focus Gallery
- ❺ Patricia D. Klingenstein Library

2

LEVEL ONE

- ❶ Notorious RBG: The Life and Times of Ruth Bader Ginsburg
Smith Gallery South
- ❷ Holiday Express: Toys and Trains from the Jerni Collection
Robert H. and Clarice Smith New York Gallery of American History
- ❸ Robert H. Smith Auditorium
- ❹ NYHistory Store
- ❺ West Gallery
- 🍷 Storico Restaurant

1

Safety Protocols

Health Screening

We kindly ask that you refrain from visiting if within the past 14 days you have experienced COVID-19 symptoms, have tested positive, or have knowingly been in contact with someone who has tested positive or has experienced COVID-19 symptoms.

An inherent risk of exposure to COVID-19 exists in any public place where people are present. People visiting the New-York Historical Society do so at their own risk.

Hygiene

Hand sanitizers are available throughout the building. Maintenance staff performs enhanced cleaning throughout the day.

Services for visitors who are deaf or hard of hearing



Most exhibition audio is accessible to t-coil hearing aid users.



Assistive listening devices and neckloops are available in the auditorium.



All exhibition films and videos are open captioned. Transcripts of *New York Story* are available. Please ask a staff member for assistance.

Services for visitors who are blind or have low vision



Text for major exhibitions is available in Large Print. Please inquire at Admissions.

Services for visitors with mobility impairments



The building, galleries, and auditorium are wheelchair accessible, and a wheelchair accessible entrance is located at 2 West 77th Street. Wheelchairs are available to visitors free of charge. We recommend reserving in advance by calling (212) 485-9200.

Face Masks & Social Distancing

Face masks are required for all staff and visitors over the age of 2. If you need one, we will provide it free of charge. Proper social distancing of at least six feet is required.

Touch-Screen & Audio Interactives

A free, disposable stylus is available at Admissions so visitors can safely interact with touchscreens. Disposable headphones are also available.

Gallery Policies



Photography

Visitors are welcome to take photos of most exhibitions and objects, except where noted. The use of flash, tripods, and selfie-sticks is not permitted.



Bag and coat check

For safety reasons, our bag and coat check are temporarily closed.



Strollers

All of our galleries are stroller-friendly.



Baby-changing facilities

Baby-changing facilities are located in the family restroom on Level One.



Mobile devices

While we encourage the use of mobile devices to access information about collections and exhibitions, please do not place phone calls in the galleries.